

CEILING-MOUNTED SPEAKERS

Resin Panel

WS-TN05N

6w

NEW



Resin Panel

WS-TN06N

6w

NEW



- The WS-TN05N/TN06N ceiling type speaker systems to be used in public address systems in combination with the volume controllers WZ-VC series.

Connection System

Emergency playback is available when using speaker volume controller WZ-VC106E/F series (optional) with 3-wire connection is applied.

Dimensions

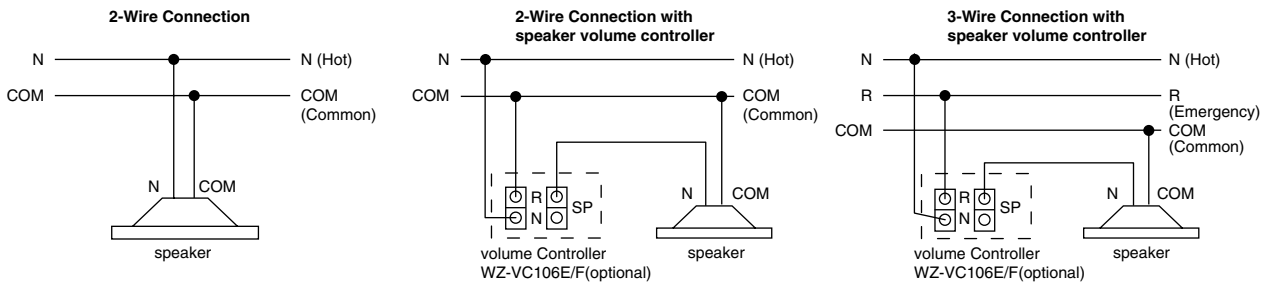
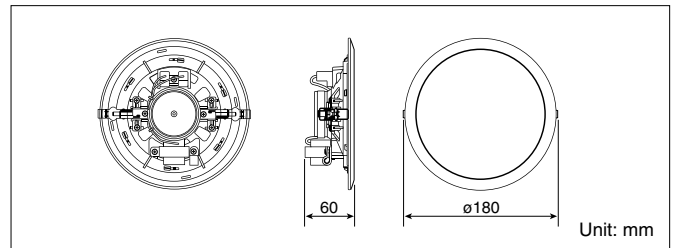

Note:

The R (Emergency) of volume controller and COM should be short-circuit when 2-wire connection is applied.

Business Patners :

EUROCOIN SALES & SERVICES SDN. BHD.
(Co No 236371-A)

35, Jalan SS 15/4C, Subang Jaya
47500 Selangor

Tel: 5637 3000 Fax: 5637 1000

E-mail address: info@eurocoin.com.my

Website: www.eurocoin.com.my

SPECIFICATIONS

Model No.	WS-TN05N	WS-TN06N
Input Impedance	1.67 kΩ/3.3 kΩ/10 kΩ	
Power Handling Capacity [RMS]	6 W (1.67 kΩ)/3 W (3.3 kΩ)/1 W (10 kΩ)	
Output Pressure Level	93 dB (1 m/1 W)	
Frequency Response	100 Hz ~ 18 kHz (-20 dB)	
Speaker Unit	12 cm cone type	
Operating Temperature	-20 °C ~ +50 °C	
Hole-on-Ceiling	ø150 mm ~ ø160 mm	
Dimensions	Diameter: 180 mm Height: 60 mm	
Weight	approx. 480 g	
Finish	Frame: ABS resin, Integrated White (Munsell 10Y9/1) Net: Integrated PP, Integrated White (Munsell 10Y9/1)	Frame: ABS resin, Integrated White (Munsell 10Y9/1) Net: Punched Aluminum, Integrated White (Munsell 10Y9/1)

*Refer to the speaker color samples on Page 52.

Set the impedance selectors of the speakers so that the total of the related input to the speakers matches with the rated output of the amplifier.

- Connect to the output cable.
- Please cut out the excess input cable after installation to avoid short-circuit.

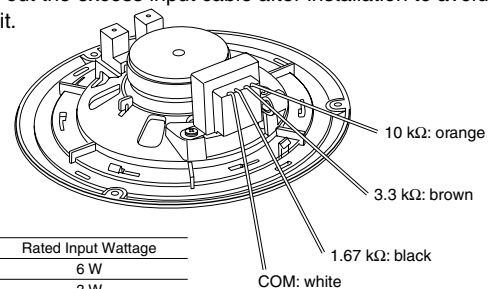

Impedance	Rated Input Wattage
1.67 kΩ	6 W
3.30 kΩ	3 W
10 kΩ	1 W